

## Item description/product images



## Description

**Material:**

Carbon steel.

**Version:**

Tempered, black oxidised.

Precision diameters ground.

## Drawings

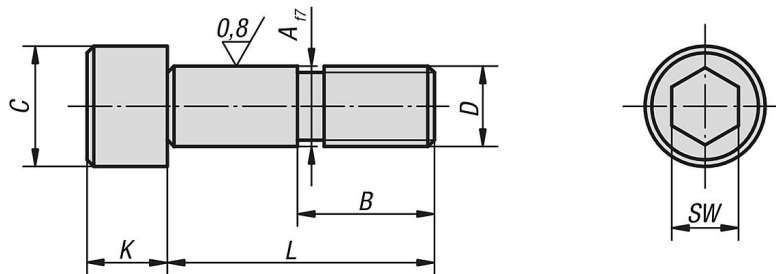

## Overview of items

Order No.	Form	A	B	C	D	K	L	SW	Tightening torque max. Nm
07533-112045	A	12	22	18	M12	12	45	10	88
07533-112055	A	12	22	18	M12	12	55	10	88
07533-112065	A	12	22	18	M12	12	65	10	88
07533-112075	A	12	22	18	M12	12	75	10	88
07533-116055	A	16	25	24	M16	16	55	14	216
07533-116065	A	16	25	24	M16	16	65	14	216
07533-116075	A	16	25	24	M16	16	75	14	216