

## Item description/product images



## Description

**Material:**

Stainless steel 1.4301.

**Version:**

High-gloss electropolished.

**Note:**

Stainless steel retractable grips with marginal installation depth. For base and mounting plates or drawers. With return spring. The grip automatically swivels back into its resting position after use.

**Drawing reference:**

1) for countersunk screws M4

## Drawings

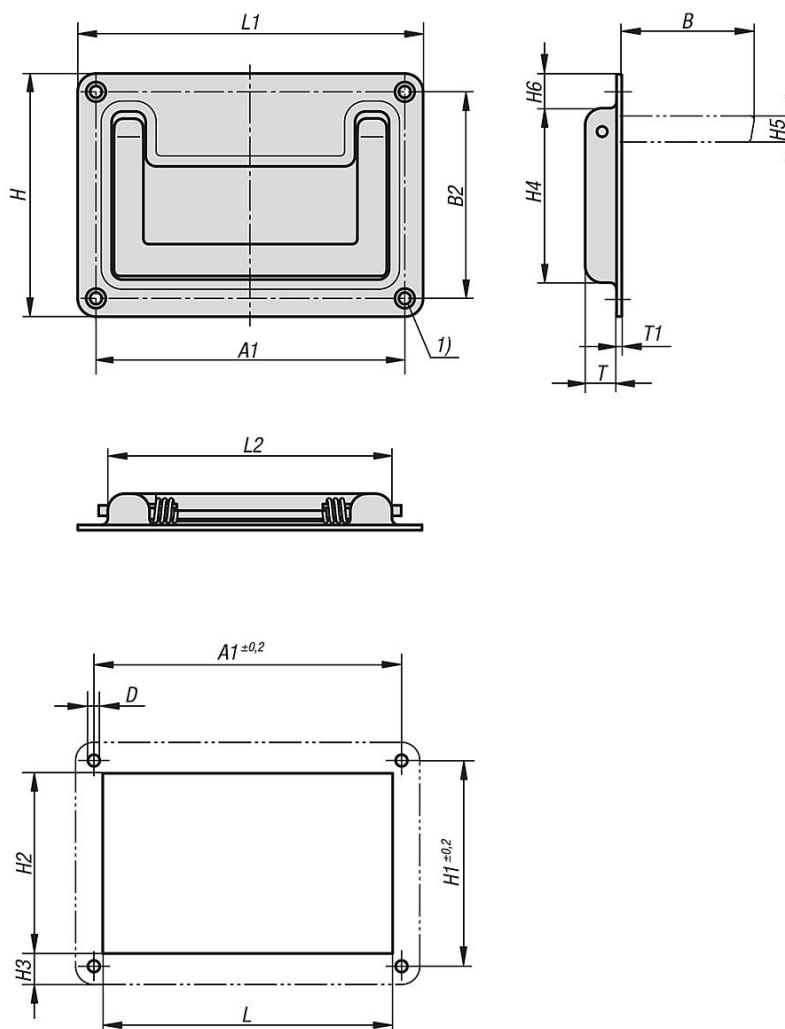

## Overview of items

Order No.	A1	B	B2	D	H	H1	H2	H3	H4	H5	H6	L	L1	L2	T	T1
06961-01-132	118±0,2	51	79	4,5	93	79±0,2	72	10,5	67	10	13	115	132	109	12	1,5