

Item description/product images



Description

Material:

Thermoset PF 31.
Steel or stainless steel.

Version:

Thermoset black, high-gloss polished.
Trivalent blue passivated steel or bright stainless steel.

Drawings

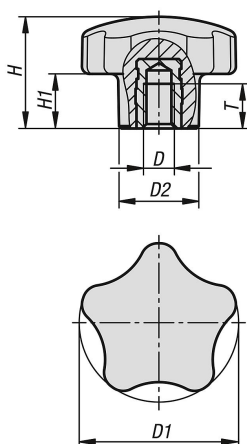

Overview of items

Order No.	Component material	D	D1	D2	H	H1	T
06851-3205	steel	M5	32	16	22,5	11	7,5
06851-3206	steel	M6	32	16	22,5	11	9
06851-4006	steel	M6	40	20	28	14	9
06851-4008	steel	M8	40	20	28	14	12
06851-4010	steel	M10	40	20	28	14	15
06851-5008	steel	M8	50	25	35	17,5	12
06851-5010	steel	M10	50	25	35	17,5	15
06851-6012	steel	M12	60	30	37	18,5	18
06851-13205	stainless steel	M5	32	16	22,5	11	7,5
06851-13206	stainless steel	M6	32	16	22,5	11	9
06851-14006	stainless steel	M6	40	20	28	14	9
06851-14008	stainless steel	M8	40	20	28	14	12
06851-14010	stainless steel	M10	40	20	28	14	15
06851-15008	stainless steel	M8	50	25	35	17,5	12
06851-15010	stainless steel	M10	50	25	35	17,5	15
06851-16012	stainless steel	M12	60	30	37	18,5	18