

Item description/product images

INCH
Parts

Description

Material:

Knobs thermoset PF 31.

Rod steel or stainless steel 1.4305.

Version:

Thermoset black, high-gloss polished.

Steel black oxidised or bright stainless steel.

Drawings

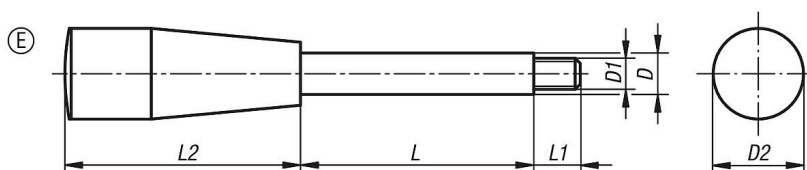

Overview of items

Order No.	Version	Form	D	D1	D2	L	L1	L2
06360-6A2X35	steel	E	8	1/4-20	17	35	9	45
06360-6A2X50	steel	E	8	1/4-20	17	50	9	45
06360-6A2X65	steel	E	8	1/4-20	17	65	9	45
06360-6A3X50	steel	E	10	5/16-18	23	50	13	61
06360-6A3X65	steel	E	10	5/16-18	23	65	13	61
06360-6A3X80	steel	E	10	5/16-18	23	80	13	61
06360-6A3X100	steel	E	10	5/16-18	23	100	13	61
06360-6A4X65	steel	E	12	3/8-16	29	65	15	71
06360-6A4X80	steel	E	12	3/8-16	29	80	15	71
06360-6A4X100	steel	E	12	3/8-16	29	100	15	71
06360-6A4X125	steel	E	12	3/8-16	29	125	15	71
06360-6A5X80	steel	E	14	1/2-13	29	80	16	71
06360-6A5X100	steel	E	14	1/2-13	29	100	16	71
06360-6A5X125	steel	E	14	1/2-13	29	125	16	71
06360-6A5X160	steel	E	14	1/2-13	29	160	16	71
06360-16A2X35	stainless steel	E	8	1/4-20	17	35	9	45
06360-16A2X50	stainless steel	E	8	1/4-20	17	50	9	45
06360-16A2X65	stainless steel	E	8	1/4-20	17	65	9	45
06360-16A3X50	stainless steel	E	10	5/16-18	23	50	13	61
06360-16A3X65	stainless steel	E	10	5/16-18	23	65	13	61
06360-16A3X80	stainless steel	E	10	5/16-18	23	80	13	61
06360-16A3X100	stainless steel	E	10	5/16-18	23	100	13	61
06360-16A4X65	stainless steel	E	12	3/8-16	29	65	15	71
06360-16A4X80	stainless steel	E	12	3/8-16	29	80	15	71
06360-16A4X100	stainless steel	E	12	3/8-16	29	100	15	71
06360-16A4X125	stainless steel	E	12	3/8-16	29	125	15	71
06360-16A5X80	stainless steel	E	14	1/2-13	29	80	16	71
06360-16A5X100	stainless steel	E	14	1/2-13	29	100	16	71
06360-16A5X125	stainless steel	E	14	1/2-13	29	125	16	71
06360-16A5X160	stainless steel	E	14	1/2-13	29	160	16	71

