

Item description/product images

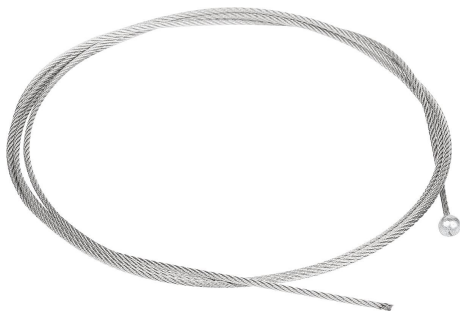

Description

Material:

Stainless steel 1.4401.

Version:

Bright.

Note:

The wire cable with end piece is a replacement part for the indexing plungers with remote actuation 03096-10.

Accessory:

Traction sleeve with inner tube 03096-20.

End sleeve 03096-25.

Setscrew 03096-30.

Screw nipple 03096-35.

Hex nut 07212.

Drawings

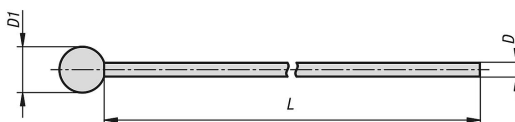

Overview of items

| Order No. | Main material | Steel code | D | D1 | L |
|---------------------|-----------------|------------|-----|----|------|
| 03096-15-10215X1200 | stainless steel | 1.4401 | 1,5 | 5 | 1200 |
| 03096-15-10215X3200 | stainless steel | 1.4401 | 1,5 | 5 | 3200 |
| 03096-15-10215X5200 | stainless steel | 1.4401 | 1,5 | 5 | 5200 |