

Item description/product images



Description

Material:
Steel.

Version:
Electro zinc-plated.



Drawings

fastening screw

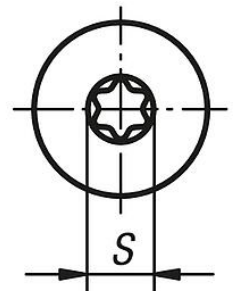
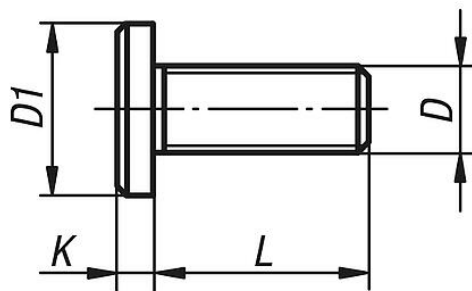

Overview of items

| Order No. | D | D1 | K | L | S | Suitable for | Tightening torque Nm |
|------------|----|----|---|----|-----|--------------|----------------------|
| 21320-0408 | M4 | 8 | 2 | 8 | T20 | size 20 | 4 |
| 21320-0510 | M5 | 10 | 2 | 10 | T25 | size 30 | 9 |
| 21320-0816 | M8 | 16 | 3 | 16 | T40 | size 45 | 22 |

