

Item description/product images



Description

Material:
Housing, steel.
Magnetic core hard ferrite.

Version:
Housing, electro zinc-plated.

Note:
Shallow pot magnets, shielded system.

Hairline cracks in the magnetic material are unavoidable for technical reasons in D=80, D=100 and D=125 versions. They do not impair the attracting function of the magnets in any way.

Temperature range:
max. 200°C.

Drawing reference:
1) magnetic face

Drawings

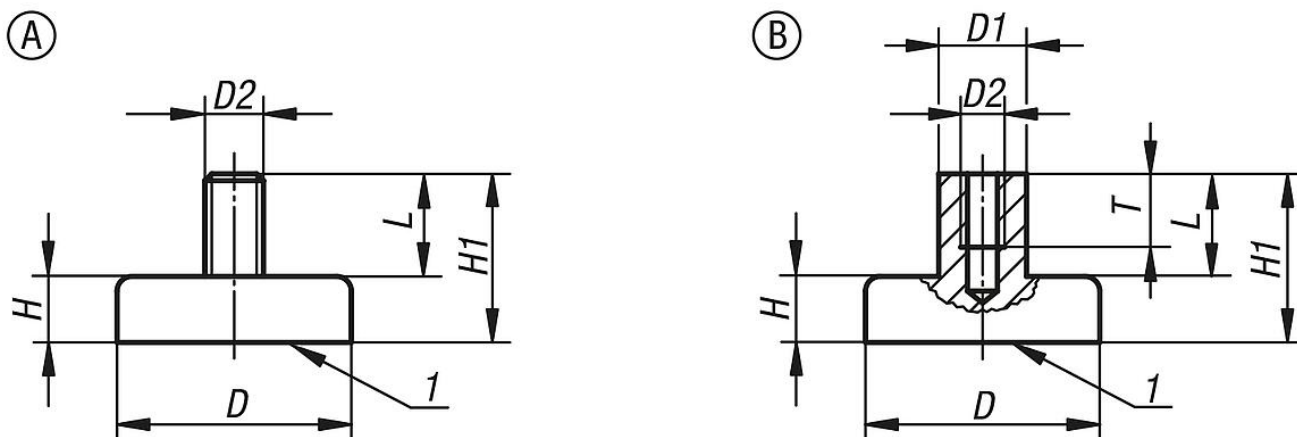

Overview of items

Order No. Form A	Order No. Form B	D	D1	D2	L	H	H1	T	Magnetic force N
09065-21	09065-01	10 ±0,15	-/6	M3	7	4,5	11,5	-/5	4
09065-22	09065-02	13 ±0,15	-/6	M3	7	4,5	11,5	-/5	10
09065-23	09065-03	16 ±0,15	-/6	M3	7	4,5	11,5	-/5	18
09065-24	09065-04	20 ±0,15	-/6	M3	7	6	13	-/5	30
09065-25	09065-05	25 ±0,15	-/8	M4	8	7	15	-/6	40
09065-26	09065-06	32 ±0,20	-/8	M4	8	7	15	-/6	80
-	09065-07	40 ±0,20	10	M5	10	8	18	8	125
-	09065-08	50 ±0,20	12	M6	12	10	22	10	220
-	09065-09	63 ±0,20	15	M8	16	14	30	14	350
-	09065-10	80 ±0,25	20	M10	16	18	34	14	600
-	09065-11	99 ±0,25	22	M12	20	22	42	17	900
-	09065-12	125 ±0,25	25	M14	24	26	50	20	1300

